



26 Avon Crescent , Alcester, B49 6BJ

£1,100 PCM



A well presented 3 Bedroom Semi-Detached family home situated in Alcester. This property comprises of porch area, open living and dining space, modern kitchen and pantry. Stairs leading to three double bedrooms and separate family bathroom.

A Holding Deposit of £369 will be taken at the point of application acceptance and will be deducted from the first months rent due on tenancy commencement date. Lamberts is a member of Propertymark which is a client money protection scheme, and also a member of The Property Ombudsman which is a redress scheme.

COUNCIL TAX BAND: Band E - Bromsgrove (Correct at the time of marketing commencement)
EPC Rating: D (60) (Correct at the time of marketing commencement).



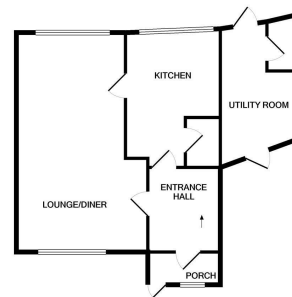

GROUND FLOOR
APPROX. FLOOR
AREA 390 SQ.FT.
(54.8 SQ.M.)



1ST FLOOR
APPROX. FLOOR
AREA 548 SQ.FT.
(55.9 SQ.M.)
TOTAL APPROX. FLOOR AREA 1137 SQ.FT. (105.7 SQ.M.)
The plan is not drawn to scale and is for illustrative purposes only.
Made with Maptive 10022

Energy Efficiency Rating		Current	Potential
Very energy efficient - lower running costs			
(92 plus) A			85
(81-91) B			
(69-80) C			
(55-68) D			
(39-54) E			
(21-38) F			
(1-20) G			
Not energy efficient - higher running costs			
England & Wales		EU Directive 2002/91/EC	

Environmental Impact (CO ₂) Rating		Current	Potential
Very environmentally friendly - lower CO ₂ emissions			
(92 plus) A			
(81-91) B			
(69-80) C			
(55-68) D			
(39-54) E			
(21-38) F			
(1-20) G			
Not environmentally friendly - higher CO ₂ emissions			
England & Wales		EU Directive 2002/91/EC	

These particulars, whilst believed to be accurate are set out as a general outline only for guidance and do not constitute any part of an offer or contract. Intending purchasers should not rely on them as statements of representation of fact, but must satisfy themselves by inspection or otherwise as to their accuracy. No person in this firm's employment has the authority to make or give any representation or warranty in respect of the property.